

COUNTRY CORNER DEVELOPMENT Project Data & Analysis

COUNTRY CORNER SHOPPING CENTRE					
Bldg. Descript.	Floor	Enclosed Area	Covered Area	Parking Req.	Park. Prov.
Building A. Rest.	Ground	4,110	4,548	22.01	22.00
Building A. Off. & Stor.	2nd Floor	1,766	2,202	7.34	8.00
Building B. Office	Ground	3,252	3,467	11.56	12.00
Building C. Retail	Ground	3,124	3,373	11.24	12.00
Building C. 2nd Floor (New)	2nd Floor				
Building D. (New)	Ground	7,882	9,938	33.13	33.00
	2nd	6,949	9,998	9.00	9.00
	3rd	6,949	9,508	9.00	9.00
	Roof	183	1,029	3.43	4.00
Total Building D		21,963	30,473	54.56	20.00
Grand Total		34,215	44,063	106.71	127.00

General Notes

- All prices are the property of Architect and must be returned at the completion of the work.
- All dimensions given must be cross checked by the contractor before and during the work and any discrepancy noted are to be reported immediately to the architect.
- This architectural drawing is given in strict confidence and shall be used only in accordance with the agreement with Architect. No other use, distribution or application may be made without the prior consent of Architect. All current laws of copyright and otherwise are hereby specifically reserved.

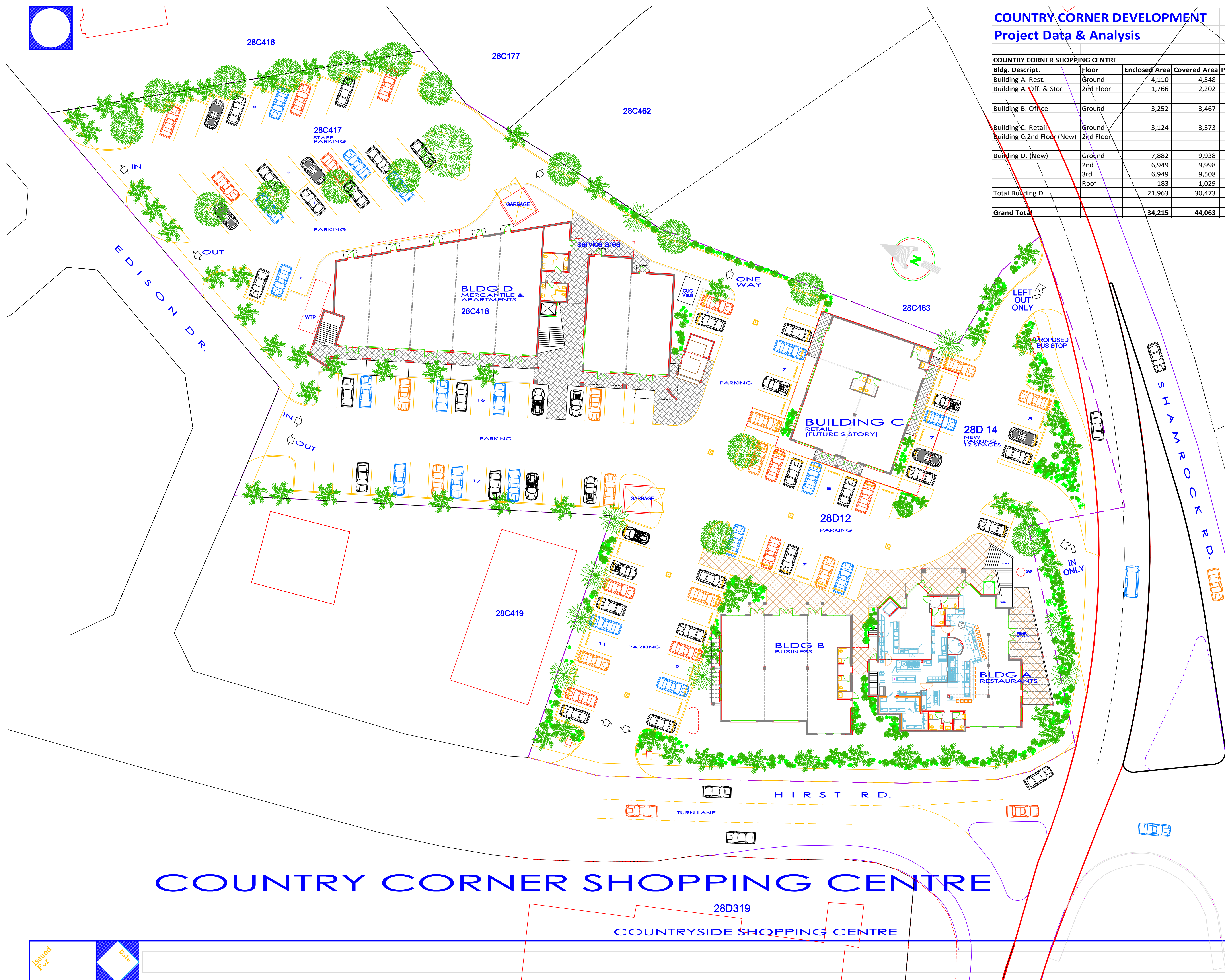
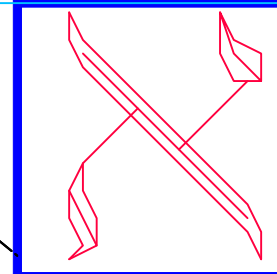

COUNTRY CORNER SHOPPING CENTRE

Revision Notes	Date

Project
**COUNTRY CORNER, SAV.
B&P 28D12 & 14, 28C417 & 418**

Title
SITE MASTER PLAN

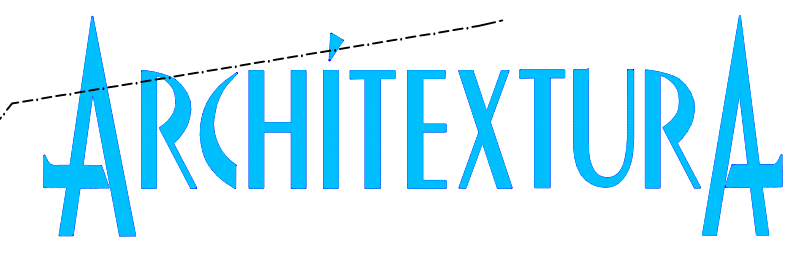

PROGRESSIVE ARCHITECTURE & DESIGN
PO Box 2694, Grand Cayman KY1-1111, CAYMAN ISLANDS
PHONE: 345.945.8855 / 345.916.4751
EMAIL: AXA@CANDW.KY

Proj # 216021.18	Scale 1"=20'	Date May '18
Dwg # A001.1	Drawn/Checked	Rev

Issued For	Date

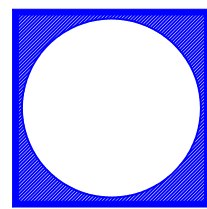

General Notes

1. All prices are the property of Architextura and must be returned at the completion of the work.
2. All dimensions given must be cross checked by the contractor before and during the work and any discrepancy noted are to be reported immediately to the architect.
3. This architectural drawing is given in strict confidence and shall be used only pursuant to the agreement with Architextura. No other use, distribution or application may be made without the prior consent of Architextura. All current laws of copyright and otherwise are hereby specifically reserved.

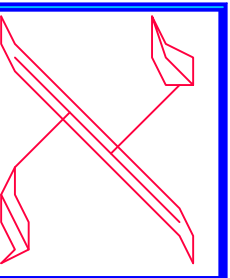

Revision Notes	Date

Project
 COUNTRY CORNER, SAV.
 B&P 28D12 & 14

Title
 SITE PLAN

ARCHITEXTURA

PROGRESSIVE ARCHITECTURE & DESIGN
 PO Box 2694, Grand Cayman KY1-1111, CAYMAN ISLANDS
 PHONE: 345.945.6855 / 345.916.4751
 EMAIL: AXA@CANDW.KY

Proj # 216021	Scale 1"=20'	Date May '18
Dwg # A101.1	Drawn Checked	Rev

Issued For	Date
------------	------

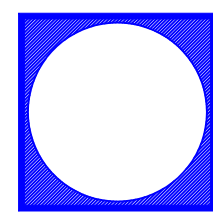

General Notes

- 1. All prices are the property of Architectura and must be returned at the completion of the work.
- 2. All dimensions given must be cross checked by the contractor before and during the work and any discrepancy noted are to be reported immediately to the architect.
- 3. This architectural drawing is given in strict confidence and shall be used only pursuant to the agreement with Architectura. No other use, distribution or application may be made without the prior consent of Architectura. All current laws of copyright and otherwise are hereby specifically reserved.

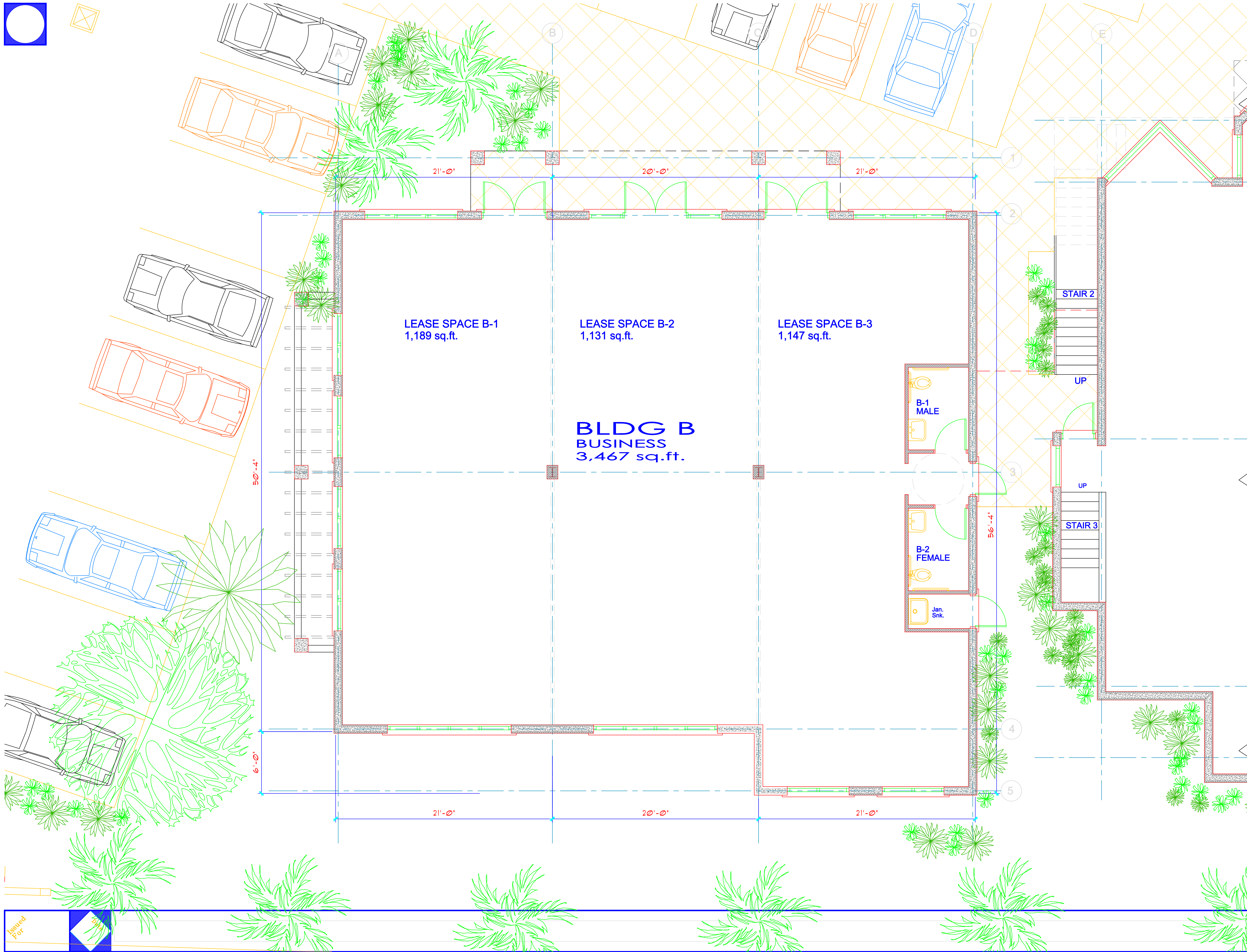
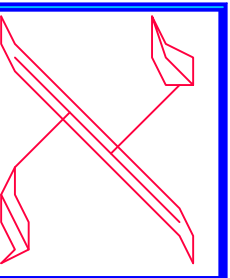

Revision Notes	Date

Project
 COUNTRY CORNER
 SAVANNAH, 28D12&14

Title
 BUILDING B
 FLOOR PLAN

ARCHITECTURA

PROGRESSIVE ARCHITECTURE & DESIGN
 PO Box 2694, Grand Cayman KY1-1111, CAYMAN ISLANDS
 PHONE: 345.945.6855 / 345.916.4751
 EMAIL: AXA@CANDW.KY

Issued For

Proj #	216021	Scale	1/4"=1'	Date	Dec.'16
Dwg #	A102.5	Drawn/Checked		Rev	

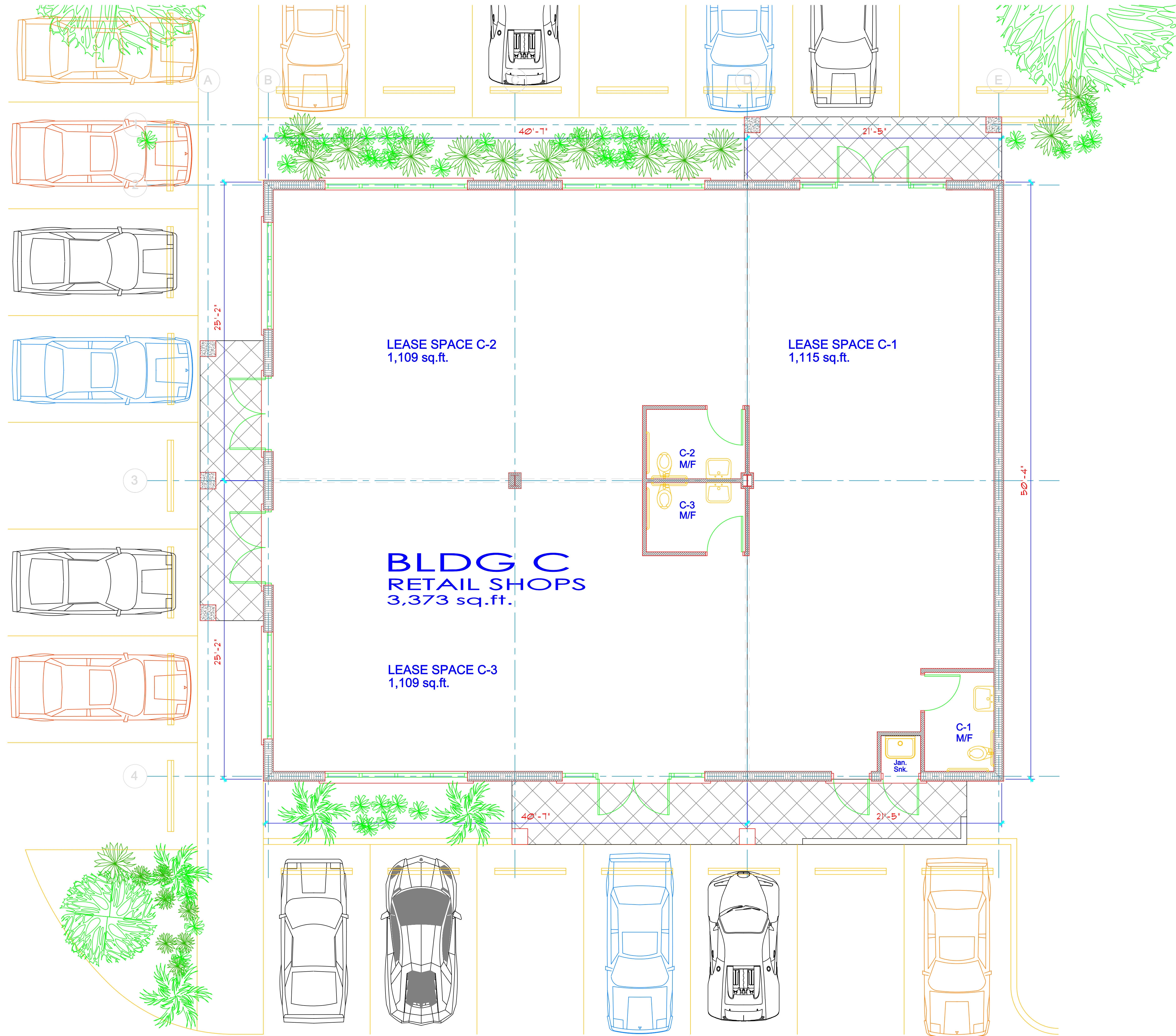
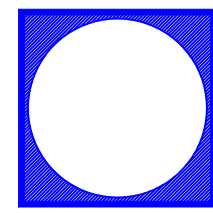

General Notes

1. All prices are the property of Architettura and must be returned at the completion of the work.
2. All dimensions given must be cross checked by the contractor before and during the work and any discrepancy noted are to be reported immediately to the architect.
3. This architectural drawing is given in strict confidence and shall be used only pursuant to the agreement with Architettura. No other use, distribution or application may be made without the prior consent of Architettura. All current laws of copyright and otherwise are hereby specifically reserved.

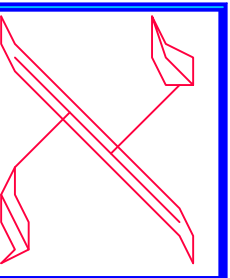

Revision Notes

Date

Project
 COUNTRY CORNER
 SAVANNAH, 28D12

Title
 BUILDING C
 FLOOR PLAN



PROGRESSIVE ARCHITECTURE & DESIGN
 PO Box 2694, Grand Cayman KY1-1111, CAYMAN ISLANDS
 PHONE: 345.945.8855 / 345.916.4751
 EMAIL: AXA@CANDW.KY

Proj # 216021	Scale 1/4"=1'	Date Dec.'16
Dwg # A102.6	Drawn Checked	Rev A

Issued For: _____ Date: _____